

In addition to the liability explicitly associated with the types of work detailed on the drawing take note of the above:  
It is assumed that all work on this drawing will be carried out by a competent contractor working, where appropriate, to an appropriate method statement.

Construction Phase	Maintenance/Cleaning Phase	Demolition / Adaptation Phase

## LEGEND

- Routes Shared by Contractor**  
Area to be kept clear from debris, materials & equipment at all times. Relevant site signage to be provided. Fire escape routes to be maintained at all times.  
Restricted use of passenger lift during construction subject to agreement with Queens Estates
- No access available for Contractor**
- Site Compound**  
Site compound within parking spaces owned by QUB directly adjacent to the building. Contractor to secure compound from general public access by use of temporary hoarding and gates. All materials, construction waste and equipment to be stored within compound. Relevant site signage to be provided.
- Area access to be left clear for maintenance**
- MBC Building Zone 3 Existing Occupants**  
**The Lower Ground Floor is occupied. Work not to disrupt occupants activities.**
- Contractors Work Areas**  
Areas to be secured from general public access and relevant site signage provided. Area to be isolated by temporary dust sheeting and screening during periods of dusty work.
- Contractors Work Route**  
Limited route within occupied floor for access to minor lower ground demolition works.
- Site Entrance Point**

## NOTES

- Dust Control**  
All dusty operations should be controlled by the greatest extent practicable by wetting or damping down or by containment. As far as practicable possible roadways should be hard surfaced and kept clean or wet to avoid dust.
- Construction Signage**  
Construction site signage must be kept clean & properly maintained. All signage must comply with the Health & Safety 'Safety, Signs & Signage' regulations - latest edition. Temporary fire escape signage must be provided throughout.
- Noise**  
Noise management must conform to 'The Noise at Work Regulations 1989'.
- Fire Escape Routes**  
Contractor to ensure passage of personnel and materials is to be restricted to work area and identified routes only. All existing fire escape routes and staircases are to remain operational during construction work.
- General Notes**  
The QUB Disruption Schedule template must be completed/updated by the Main Contractor at least 2 weeks prior to work commencing.
- Isolation of Work Areas**  
Adequate measures should be taken to isolate and secure work areas for public access.
- Hoarding**  
Contractor will be required to provide solid hoarding 3.2m in height to the site compound at car park and to secure site perimeter from unauthorized access out of hours. Proposed hoarding location to be submitted to contract administrator for acceptance.

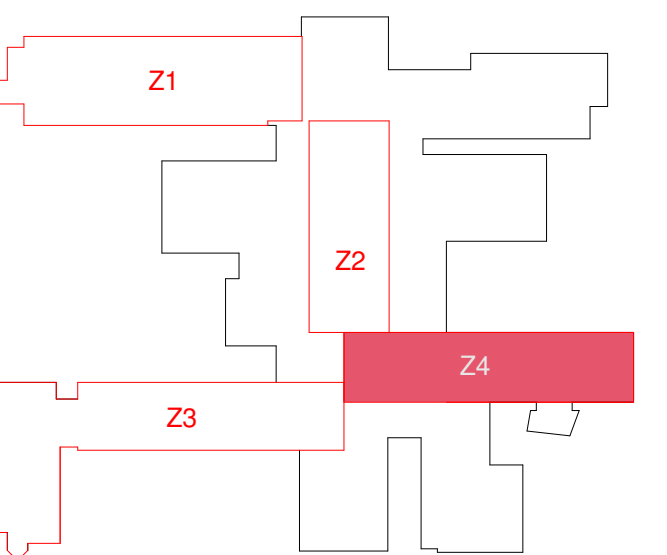

Rev	Description	Date	Issued by
PD0	Revised and Re-issued for Tender	29.01.20	CF
PD2	Issued for Tender	04.02.20	CF
PD1	Issued for Cladding	19.11.20	CF

1892 - QUB BioMedical Library Interim Expansion		1892 - OW1 - XX - 00 - DR - A - 0780	
LEVEL 00 CONTRACTORS WORKS			
Revision	PD0	Drawn by	CF
Status	PD - Issued for Tender	Checked by	MY
Scale	As indicated @ A0	Approved by	MY
Date	19.11.20		

Notes:  
1. Large scale drawings take precedence over small scale drawings.  
2. Any discrepancies in information are noted in circles - referring to clarification.  
3. Do not take dimensions from this drawing, refer to dimensions only to be followed.

ARCHITECTS AND PLANNERS  
14 Edgewood Road, Edgewood Office Park, Belfast BT3 9JQ  
T: +4428 9077 8810 E: architecture@ostickwilliams.com  
© Copyright in this drawing remains the property of Ostick + Williams Ltd under copyright agreement.