



Queen's
Accommodation



Queen's University
Belfast

QUEEN'S ACCOMMODATION OPEN DAY GUIDE 2017



stayatqueens.com

97% OVERALL
STUDENT
SATISFACTION
IN 2015-16



£ ALL INCLUSIVE PRICE

WE HAVE THE LOWEST ACCOMMODATION
COSTS OF ANY RUSSELL GROUP
UNIVERSITY

4 hr INCLUSIVE
EMERGENCY
MAINTENANCE
COVER



**FREE HIGH SPEED WIFI
AND 50MB BROADBAND
IN EVERY BEDROOM**

300 TRIPS AND EVENTS
ORGANISED BY OUR
RESEDENTIAL LIFE
TEAM LAST YEAR



24/7 RECEPTION AND
SAFETY TEAM
PRESENT

OUR FRIENDLY STAFF ARE ALWAYS HERE FOR YOU.
WE OFFER A 24/7 CONTACT SERVICE FOR
PARENTS, OFFERING PEACE OF MIND

Welcome to Queen's University Belfast Accommodation Open Day

At Queen's University Belfast, we have a great choice of accommodation for you to choose from. Our aim is to provide you with a safe and comfortable home at great value, as well as ensuring that your time with us is enjoyable and fun. We hope that our Open Day will give you an insight into the different types of accommodation that we offer, and help you decide which type suits you best.

Reasons to choose Queen's Accommodation

The accommodation provided by Queen's University is more than just a room. We not only provide fantastic stylish room, but a fun living space where you will make amazing friends as you join a multi-cultural community. We are committed to providing a comfortable living and learning environment as you undertake world class education and research. We have a range of self-catered options to suit every student's need and budget with prices starting from just £71* per week. No matter which residence you choose, you will have your own study bedroom, great amenities and a friendly supportive environment in which to live. Our Residential Life team will help provide new experiences through a weekly programme of events and trips helping you create a wide network of friends.

There are many great reasons to choose Queen's Accommodation including

- Our friendly staff are always here for you, and we offer a 24/7 contact service for parents, offering peace of mind.
 - Our Safety team are on hand 24/7.
 - Our Residential Life team create a supportive community and environment in which to live. They create opportunities to make new friends and provide new experiences, organising over 300 trips and events each year.
 - Range of facilities on site including a computer lounge with printing facilities, a social space with BT Sport, pool table and table tennis, a laundry, and a Club Room - Quiet Space. We are also just a ten minute walk from Queen's Sport, Students' Union and McClay Library.
 - Fully inclusive maintenance cover including a four hour emergency call out 24/7.
 - Contents insurance provided by Endsleigh Insurance and a television licence for communal areas.
- Prices are inclusive of all utilities with the exception of Willow Walk where charges may be incurred if you use more than the credit provided: heating, hot water, electricity, high speed Wifi and 50MB of broadband in every room in 2016/17.

**Prices from 2016/17*





Residential Fees 2016-17

Elms Village	Weekly Price	38 week contract	39 week contract	51 week contract
Standard Room	£94	£3,572	£3,666	£4,794
Premium Standard Room	£104	£3,952	£4,056	£5,304
En Suite	£112	£4,256	£4,368	£5,712
Premium En Suite	£123	£4,674	£4,797	£6,273
Queen's Houses (76 Malone Road, Grant House, College Gardens, Mount Charles, Guthrie House)	Weekly Price	38 week contract	39 week contract	51 week contract
Standard Twin	£71	£2,698	£2,769	£3,621
Small Standard	£119	£4,522	£4,641	£6,069
Standard	£94	£3,572	£3,666	£4,794
Standard Premium	£104	£3,952	£4,056	£5,304
Standard Premium Double (Single Occupancy)	£112	£4,256	£4,368	£5,712
En Suite Premium	£123	£4,674	£4,797	£6,273
Lifestyle Options: We are able to offer the following lifestyle options: Single Sex, Quiet Living and No Alcohol. We aim to be able to group like-minded people together and students living in these blocks are requested to adhere to the ethos of the accommodation they have agreed to live in.				



Elms Village

Elms Village is purpose built student accommodation with first year undergraduate students in mind. We offer a range of modern, comfy and secure accommodation.

Set in a residential location, there are 50 three-storeyed accommodation blocks (see map at end of booklet). Each floor has 10-11 bedrooms with a shared common room and kitchen.

There is a choice of four bedroom types: standard, standard premium, en suite and en suite premium. Standard rooms have a washbasin in the room and share a bathroom between 4-5 other residents.

The Treehouse is at the heart of Elms Village. The Residential Life team are based here and it also contains a computer suite with printing facilities, the Laundry, Club Room - Quiet Space, The Lounge social space, an ATM and a Mace which serves grab and go snacks and drinks.



Student Houses

Our student houses are offered in five locations near to the main Queen's campus (see map at the back of this brochure for details). Each site provides accommodation for students who prefer a more independent lifestyle.

Students living in these properties are also supported by the Residential Life team, receive a weekly cleaning service of communal areas and have full maintenance support.

Further details of each property is available via our website www.stayatqueens.com





Residential Fees 2016-17

Willow Walk	Weekly Price	38 week contract	39 week contract	51 week contract
Studio	£129	£4,902	£5,031	£6, 579
1 Bedroom Apartment	£160	£6,080	£6,240	£8,160
2 Bedroom Apartment	£129	£4,902	£5,031	£6, 579
2 Bed Premium	£139	£5,282	£5,421	£7,089
3 and 4 Bed Apartments	£123	£4,674	£4,797	£6,273

Willow Walk

- Purpose built for international students and postgraduates
- Each study bedroom has a double bed except the studio apartment which has a single bed
- The gas and electricity meters in each apartment have been uploaded with credit which is based on the historic usage for each apartment. This is sufficient to meet the requirements for the length of the contract. Should you use more than the amount of credit provided, you will be required to pay for the additional cost.



Willow Walk

Willow Walk is purpose built accommodation ideally suited to the needs of international and postgraduate students. Willow Walk is located in an enclosed development on the perimeter of Elms Village and rivals the best private sector competitors, with the added advantage of University control and management in areas such as security, maintenance and contract terms. Everything you need is within walking distance from Willow Walk which means there are no transport costs to get to Queen's campus for lectures, McClay Library, to sport and recreation at Queen's Sport venues or to Queen's Students' Union.

The accommodation offers a mix of studio and one, two, three or four bedroom apartments each with their own front door. The apartments enjoy a

modern contemporary design and level of finish and share an exclusive common room.

The residents of Willow Walk receive the same services as other residents of Queen's Accommodation with the following exceptions:

- cleaning of communal areas occurs approximately every six weeks
- gas and electricity meters in each apartment have been uploaded with credit which is based on the historic usage for each apartment. This is sufficient to meet the requirements for the length of the contract. Should you use more than the amount of credit provided, you will be required to pay for the additional cost. In order to avoid having to pay extra cost and to reduce waste we would advise that you use the heating and electricity sensibly.



Residential life team

Your welfare and safety are truly important to us and to support you we have on site pastoral support and a 24/7 Safety team. Our Residential Life Co-coordinators are here to provide support and guidance to all students living in Queen's Accommodation. They also work hard to keep our residents informed about the latest events and trips that they organize via our Queen's Accommodation Facebook page. They are supported by 16 Residential Assistants who are students employed by the University to promote a sense of community within each residence and help maintain the health and safety of all residents. They can also assist with pastoral support and in emergency situations.

The Residential Life team organise over 300 events each year which are informed by student choice. Activities include hill walking, pizza and movie nights, trips to Glasgow and visits to local attractions such as Belfast Zoo or Crumlin Road Gaol. There are also regular trips to local supermarkets and Ikea!



At Queen's University Belfast we offer an Easy Pay system where cash can be loaded on to your student card which can then be used to pay for food from our catering partners across campus. This includes Clements (Students' Union, PEC and MBC), Cafe Krem (ECIT, DKB and Krem Kart in PFC) and Hope (McClay Library).



Making your decision

To apply for Queen's Accommodation please complete the online application available on our website www.stayatqueens.com

It is important when applying for accommodation that you have considered a variety of factors to ensure you have chosen what is right for you. Consider all the accommodation types we have to offer, as well as the cost and if you have any special requirements or would prefer to live in a Lifestyle Option.

Please note, students from Northern Ireland must apply by 1 August 2016 for their application to be considered. Applications received after this date will automatically be waitlisted.

Students from outside of Northern Ireland who make Queen's their firm choice (UF and CF) by 25 July 2016 will be sent an offer of a room after this date. All other students will be allocated accommodation when they have been accepted onto a course at Queen's University Belfast, your status at the time of allocation must be unconditional firm (UF).

Allocations will begin for Northern Ireland students, on Monday 22 August 2016 and rooms will be offered on the basis of distance, from your home postcode to Queen's University BT7 1NN. The Accommodation team will not be allocating rooms to students from Northern Ireland prior to this date.



**Premium
En Suite**
Elms Village



**Standard
Room**
Elms Village





**En Suite
Standard**
Elms Village

**Premium
Standard**
Queen's House



What to bring with you

All Queen's Accommodation is furnished.

We provide the following items in your bedroom:

- Standard single or double bed with mattress
- Wardrobe with hanging rail and shelving
- Desk and chair
- Wastepaper bin
- Curtains and or other window coverings
- Desk lighting

We suggest you bring some items with you to help you settle in:

- Washing detergent for laundry and dishes
- Towels and dish drying towels
- Clothes hangers
- Crockery including plates, bowls and mugs
- Cutlery and cooking utensils, including tin opener, bottle opener
- Pans including a couple of saucepans, frying pan, baking tray
- Bed linen, including sheets, pillows and duvets or blankets
- Hairdryer and toiletries

If you do not want to bring bedding and kitchen items with you packs can be ordered before your arrival or purchased when you get here.

Prohibited Items:

Students living within University accommodation come from many international backgrounds and a variety of beliefs, religions and values. In accordance with the University Equality and Diversity Policy we do not allow anyone to display any national flags/emblems/or political slogans that may cause offence.

If an item that is considered to be dangerous or prohibited is discovered in accommodation, it will be removed by a member of staff and you may face a disciplinary investigation. Items which must not be brought into accommodation include, but are not limited to:

- Knives, firearms, replica firearms or swords, air guns, catapults water pistols, water bombs, fireworks, helium or gas canisters
- Weapons of any kind are banned and certain sports equipment, e.g. fencing foils or archery equipment, can be classified as offensive. You may only bring these into accommodation once confirmation has been received by the Accommodation Manager from Queen's Sport that you are a member of an appropriate University Club. The equipment may have to be stored in reception.

The following items are also prohibited:

- Animals, reptiles, fish, insects or birds (assistance dogs are allowed by prior arrangement)
- Electric heaters and electric blankets
- Loud speakers
- Fridges in bedrooms

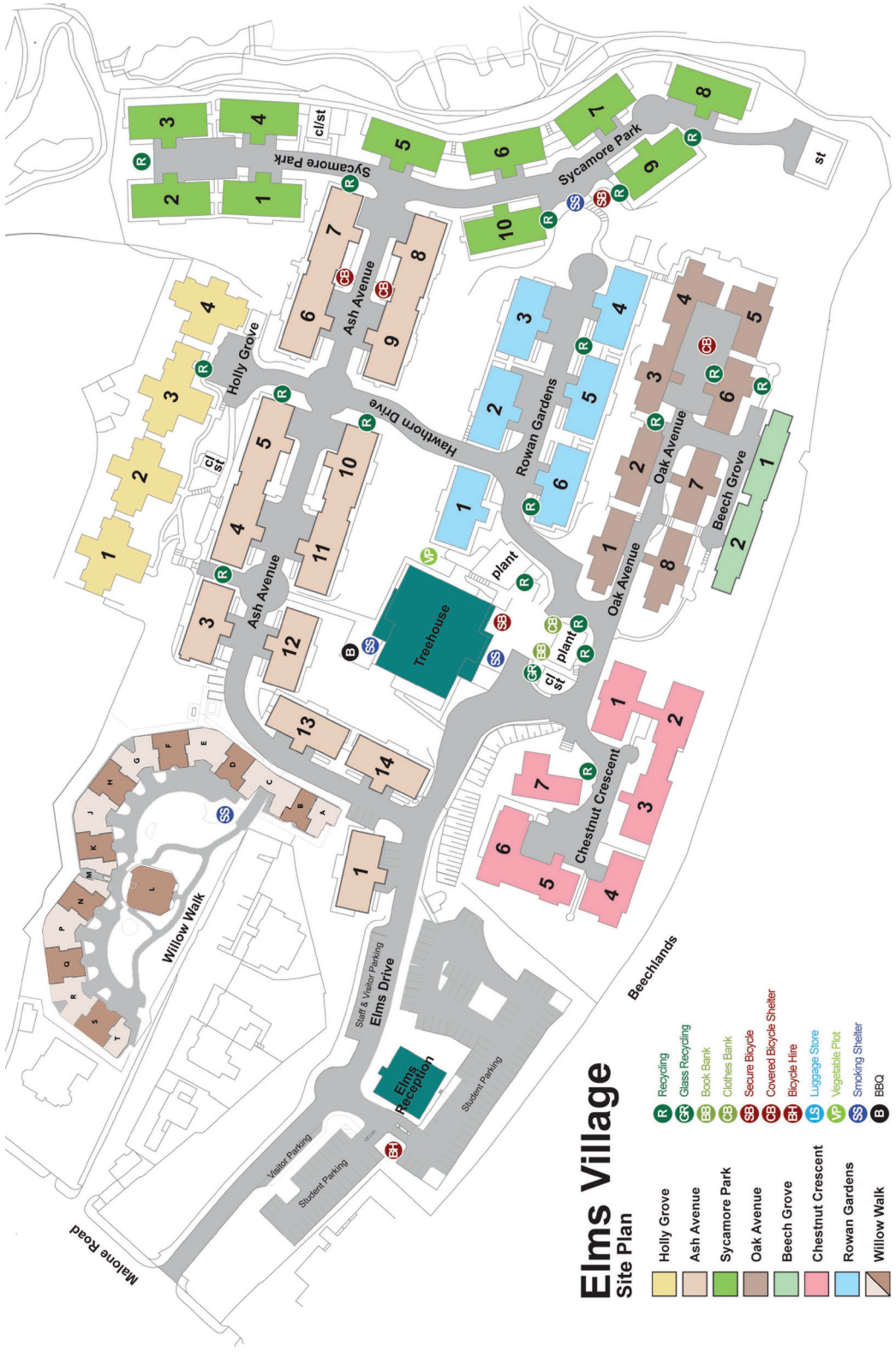

Elms Village Site Plan

- Holly Grove
- Ash Avenue
- Sycamore Park
- Oak Avenue
- Beech Grove
- Chestnut Crescent
- Rowan Gardens
- Willow Walk
- Recycling
- Glass Recycling
- Book Bank
- Clothes Bank
- Secure Bicycle
- Covered Bicycle Shelter
- Bicycle Hire
- Luggage Store
- Vegetable Plot
- Smoking Shelter
- BBQ

Queen's University Belfast Campus Map



FACULTY OFFICES

Arts, Humanities and Social Sciences	X1
Engineering and Physical Sciences	X2
Medicine, Health and Life Sciences	X3

SCHOOL OFFICES

Arts, English and Languages	F
Biological Sciences	E
Chemistry and Chemical Engineering	N
Electronics, Electrical Engineering and Computer Science	M
History, Anthropology, Philosophy and Politics	J
Law	H
Mathematics and Physics	L
Mechanical and Aerospace Engineering	R
Medicine, Dentistry and Biomedical Sciences	B
Natural and Built Environment	O
Nursing and Midwifery	C
Pharmacy	D
Psychology	P
Queen's Management School	S
Social Sciences, Education and Social Work	K

GLOBAL RESEARCH INSTITUTES

The Senator George J Mitchell Institute for Global Peace, Security and Justice	G
The William J Clinton Leadership Institute	T
The Institute for Global Food Security	U
The Institute of Electronics, Communications and Information Technology (Titanic Quarter)	
The Institute of Health Sciences	A

LOCATION

Academic and Student Affairs	3
Administration Building	3
Ashby Building	31
Canada Room/Council Chamber	1
Careers, Employability and Skills	14
Centre for Cancer Research and Cell Biology (CCRCB)	23
Chrono Centre	19
Clinical Research Facility	26
Computer Science	27
Counselling Service	14
David Bates Building	12
David Keir Building	28

Development and Alumni Relations	1
Disability Services	14
Drama and Film Centre at Queen's	10
Dunluce Health Centre	20
Elms Village	35
Elmwood Building	18
Elmwood Hall	15
Estates	3
Finance	3
Graduate School	4
Great Hall	1
Harty Room	5
Health Sciences Building	25
Human Resources	3
Information Services	11
Institute of Professional Legal Studies (IPLS)	33
International Office	1
INTO Queen's	32
Jobshop	14
Lanyon Building	1
Main Site Tower	2
Marketing, Recruitment, Communications and Internationalisation	1
McClay Research Centre	24
Medical Biology Centre (MBC)	21
Naughton Gallery at Queen's	1
New Physics Building	8
Northern Ireland Technology Centre (NITC)	30
Occupational Health and Safety Services	34
Old Physics Building	9
Peter Froggatt Centre (PFC)	2
Pharmacy Building	24
Physical Education Centre (PEC)	36
Queen's Film Theatre (QFT)	10
Registrar and Chief Operating Officer	1
Research and Enterprise	17
Riddel Hall	37
Sonic Arts Research Centre (SARC)	29
South Dining Hall	6
Student Guidance Centre	14
Student Plus	1
Students' Union	16
The McClay Library	11
University Health Centre	13
Vice-Chancellor's Office	1
Welcome Centre	1
Whitla Hall	7
Whitla Medical Building	22
Wellcome-Wolfson Institute for Experimental Medicine	23

Queen's Accommodation
78 Malone Road
Belfast
BT9 5BW
T: (028) 9097 4525
E: accommodation@qub.ac.uk

Follow us

► stayatqueens.com

f Queen's Accommodation

🐦 @QueensAccomm

📷 qub_accommodation



APPLY ONLINE:
stayatqueens.com